



Sunrise Highway – Corner Site

S/E/C Sunrise Highway & Route 107, Massapequa, New York

FACT SHEET

Address: 4222 Sunrise Highway

Layout: Land: 27,429 sq ft

Building: 7,636

Parking Spaces: 39

Current Stores:

Store #1-



Store #2 – Available

Square Footage 1,335

Base Rent: ~~\$4,400~~ Reduced to \$3,900

Store #3 - Available

Square Footage 1,849

Base Rent: ~~\$6,000~~ Reduced to \$5,400

Store #4



Surrounding Tenants: Capital One Bank, Walgreens, Sherman Williams, WAMU

525 NORTHERN BLVD. SUITE 300 GREAT NECK, N.Y. 11021

TEL: (516) 829-7300 FAX: (516) 829-4738

WWW.BELLREALTYNY.COM



Sunrise Highway – Corner Site

S/E/C Sunrise Highway & Route 107, Massapequa, New York



Other Features:

- Over 60,000 cars pass this property every day
- Located at major intersection with traffic light
- Blocks from LIRR train station

525 NORTHERN BLVD. SUITE 300 GREAT NECK, N.Y. 11021
TEL: (516) 829-7300 FAX: (516) 829-4738
WWW.BELLREALTYNY.COM



Address **4222 Sunrise Hwy**
Massapequa, NY 11758

Get Google Maps on your phone

Text the word "GMAPS" to 466453

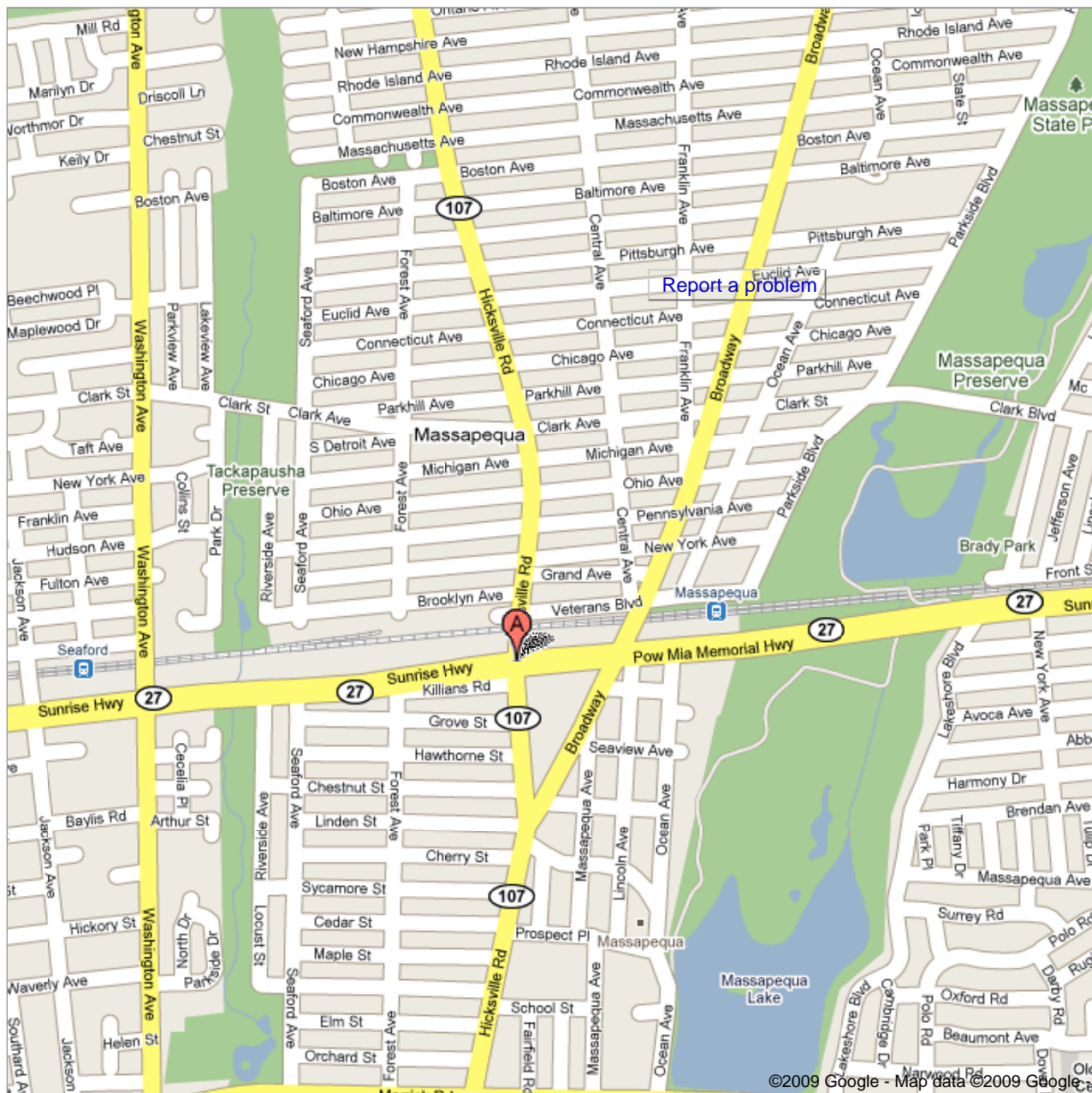

©2009 Google - Map data ©2009 Google

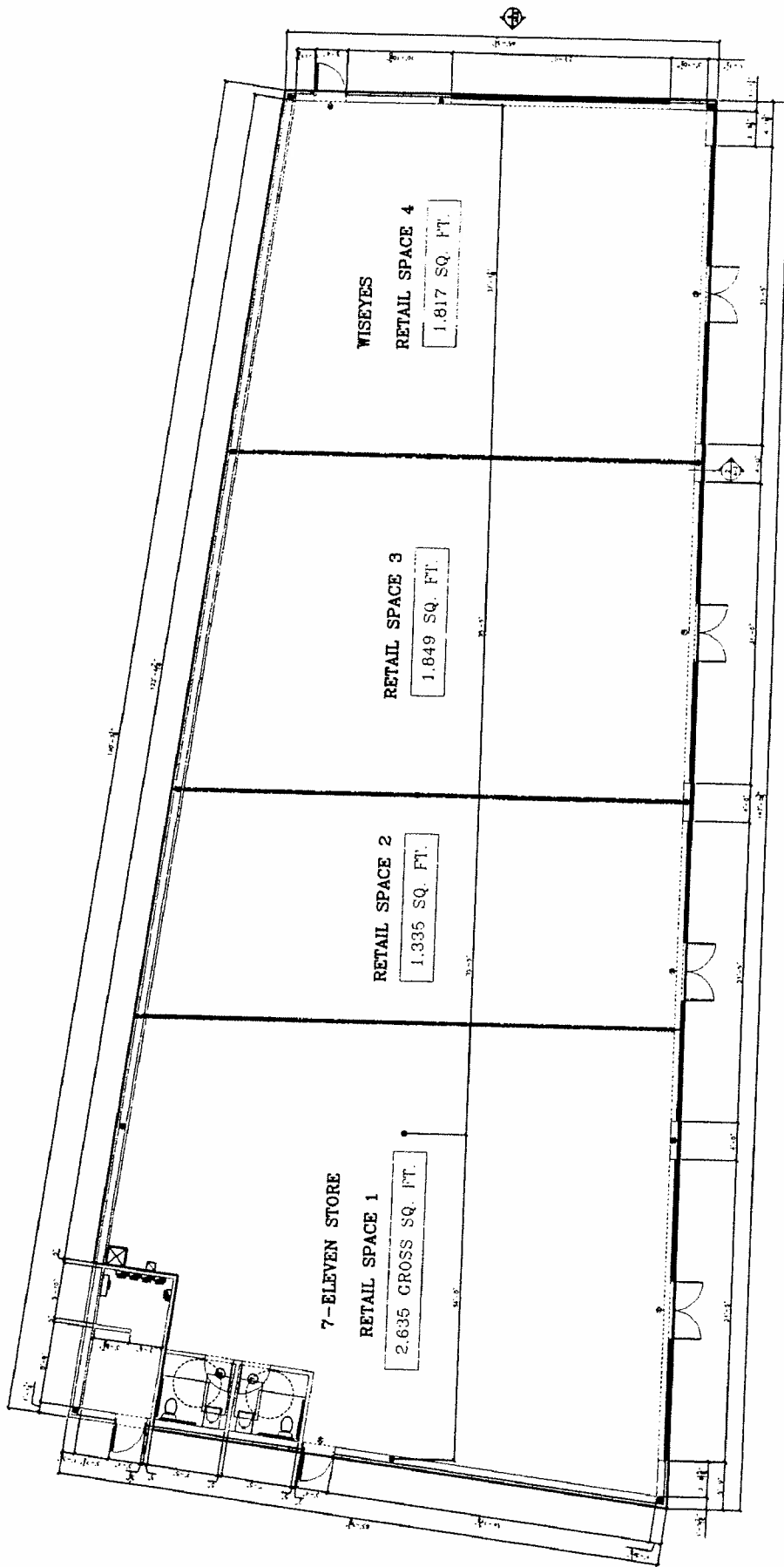

1. RETAIL SQ. FT. PLAN

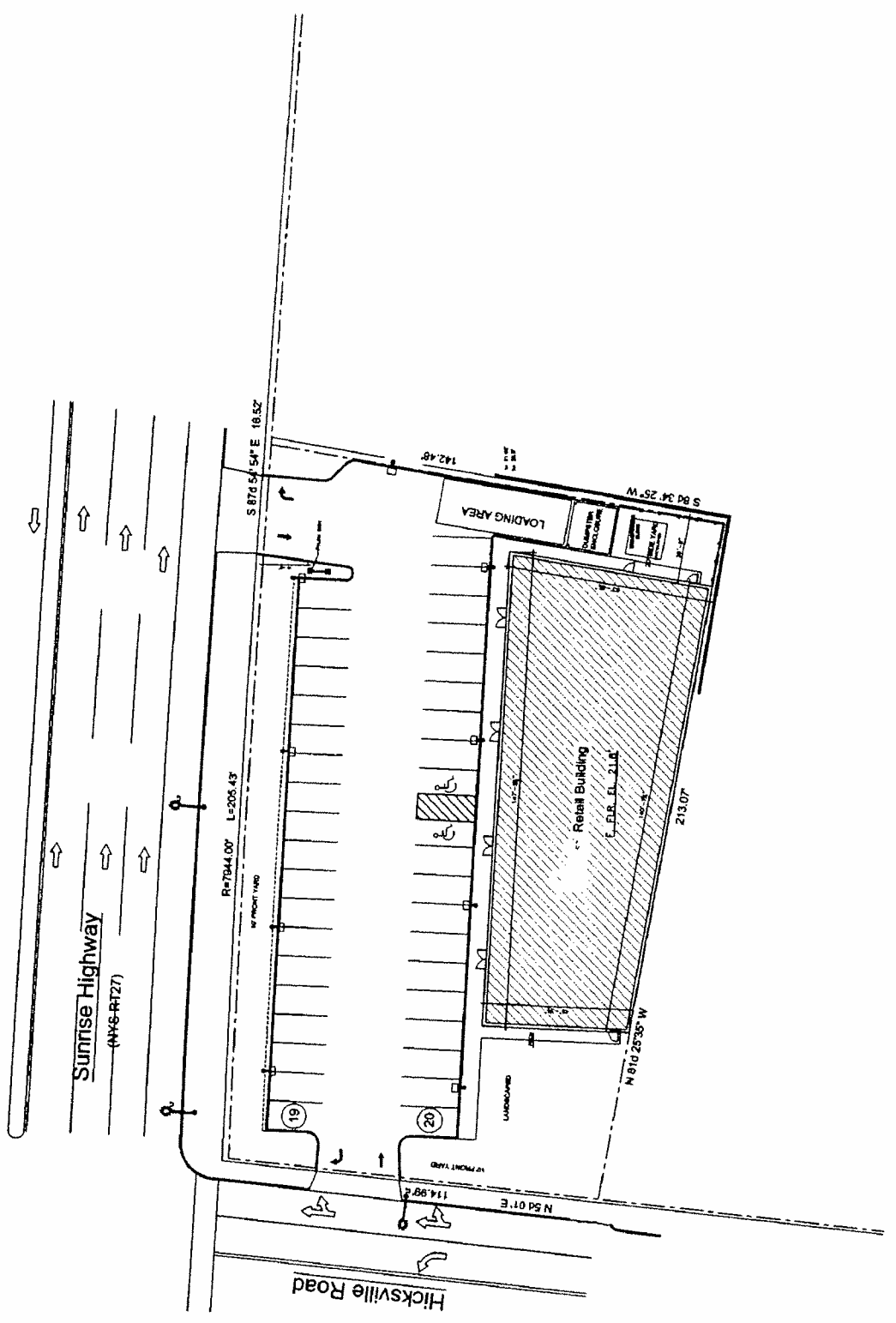

Sunrise Highway
(MS-R177)

Hicksville Road

Retail Building
E.P.R. EL. 211'

LOADING AREA

LANDSCAPED

R=7044.00' L=205.43'

S 87° 54' E 18.52'

S 84° 34' 25" W

213.07'

N 81° 25' 35" W

N 54° 07' E

14.99'

142.48'

19

20

